

Aladdin Temp-Rite®...better by degrees.

P.O. Box 2978, Hendersonville, TN 37077-2978
1-800-888-8018 or 615-537-3600
Fax 1-888-812-9956
www.aladintemprite.com



DOMESTORAGE RACKS



DR108S
Allure Soup Dome Storage rack



DR160E
Allure Dome Storage rack

DR88ET
DR108S
DR112ES
DR160E
DRXLR



DRXLR
Temp-Rite II excel & Ready Chill
Storage rack

Copyright © 1999 Aladdin Temp-Rite®

Changes may be made to the information in this document without notification.

CONTENTS

- I. SPECIFICATIONS 4**
- II. RECEIVING INSPECTIONS 5**
- III. INSTALLATION 6**
- IV. CLEANING / MAINTENANCE 6**
- V. PARTS LIST 7**
- VI . WARRANTY & LIABILITY 8**

I. SPECIFICATIONS

Model Number	DR160E	DRXLR	DR88ET	DR108S	DS112ES
Products	<ul style="list-style-type: none"> •9" Allure dome •9" Insulated base 	<ul style="list-style-type: none"> •Temp-Rite II Excel domes •8" Ready-Chill domes 	<ul style="list-style-type: none"> •HOD On Tray dome •Essence 9" dome 	<ul style="list-style-type: none"> •Allure Soup dome 	<ul style="list-style-type: none"> •9" Essence dome •9" Allure dome
Part Number	12513	12514	12515	12516	12737
Capacity (1 rack / total)	40 / 160	Entree <u>30 / 120</u> 3" soup <u>50 / 200</u> 5" soup <u>30 / 120</u> Ready Chill 30/120	22 / 88	27 / 108	28 / 112
Length	37.46" (95.15 cm)	37.46" (95.15 cm)	37.46" (95.15 cm)	37.46" (95.15 cm)	37.46" (95.15 cm)
Width	24.45" (62.10 cm)	27.157" (68.98 cm)	24.45" (62.10 cm)	24.45" (62.10 cm)	24.45" (62.10 cm)
Height	60.24" (153.0 cm)	64.52" (163.9 cm)	60.24" (153.0 cm)	61.63" (156.5 cm)	60.24" (153.0 cm)
Weight	83 lbs. (37.6 kg)	95.8 lbs. (43.5 kg)	76.6 lbs. (34.7 kg)	83 lbs. (37.6 kg)	79 lbs (35.8 kg)

II. RECEIVING INSPECTIONS

Your Aladdin Drying Rack is factory tested for performance and is free from defects when shipped. The utmost care has been taken in packaging this product to protect against damage in transit.

You should carefully inspect your Drying Rack to assure that no damage has occurred in transit. If however, damage is detected see the following damaged goods policy. Under no condition may a damaged unit be returned to Aladdin Temp-Rite without first obtaining written permission (return authorization). No credit will be issued for claims not reported to Aladdin within ten (10) business days from receipt of shipment.

ALADDIN DAMAGED GOODS POLICY

There are two types of damaged merchandise:

- Visual Damage
- Concealed Damage

Visual Damage – When the product being received is visibly damaged.

1. Receiver should not accept merchandise with visual damage.
2. Receiver must sign delivery receipt “refused merchandise due to damage” and specify damage.
3. Receiver should call Aladdin Customer Service immediately after refusal.
4. Carrier will notify Aladdin Traffic Department and a claim will be filed.
5. Carrier will send acknowledgement of claim within 7 days after receiving.

Concealed Damage – When damaged merchandise cannot be externally detected.

Any receiving operation should be looking for this type of damage. Sometimes, however, depending on the type of product, it is almost impossible to notice.

1. Merchandise must not be removed from point of delivery and all packaging must be kept intact.
2. Receiver must contact Aladdin customer service to report damage.
3. Aladdin traffic department will request inspection based on the dollar value of the cargo.
4. Aladdin traffic department will file a claim based on the findings of the inspection.

Failure to comply with these policies will result in the customer’s responsibility to file claims.

III. INSTALLATION

- Inspect exterior of box for damage. If any, see Section II Receiving inspection.
- Remove top of box from pallet
- Remove dome rack from pallet
- Inspect dome rack for damage. If any, see Section II Receiving inspection.
- Remove manual from wire rack, keep for reference
- Check that brakes are unlocked, roll rack to desired location
- Dispose of packaging

IV. CLEANING / MAINTENANCE



CAUTION



Harsh chemicals and insufficiently diluted sanitizers will damage stainless steel surface. Never use cleaning agents that contain phosphates or chlorides. These chemicals will cause permanent damage to the stainless steel finish, and void equipment warranty.

The Aladdin Dome Racks should be sanitized and cleaned after each use using the following method

1. Wipe down frame and wire guides with a soft clean cloth, using warm water and a mild detergent. (It is recommend that you wipe with the grain of the surface to avoid scratches.)
2. Use a soft nylon brush on any food buildup and in corners.
3. Sanitize with a properly diluted sanitizer (according to manufacturers recommendations).
4. Dry thoroughly with a dry cloth to remove moisture.
5. Never use sharp objects, abrasives or scrapers.
7. Do not wash dome rack in a pressurized wash system.
8. Check caster for debris

V. PARTS LIST

#	Qty	Sales Code	Part Number	Description
1	1	Y104S	93397	Frame assembly (cap, frame, & casters)
2	2	-	93464	5" stem swivel caster
3	2	-	99841	5" stem swivel caster with brake
4	4	-	99839	Tube cap
5	4	J88	75081	9" Allure Entree, 9" insulated base dome wire rack
6	4	J88E	75060	TRII Excel / Ready-Chill dome wire rack
7	4	J82EPL	99027	Ontray, 9" Essence dome wire rack
8	4	J88S	12438	Allure soup dome wire rack
9	4	J88ES	12738	Essence, 9" Allure dome wire rack

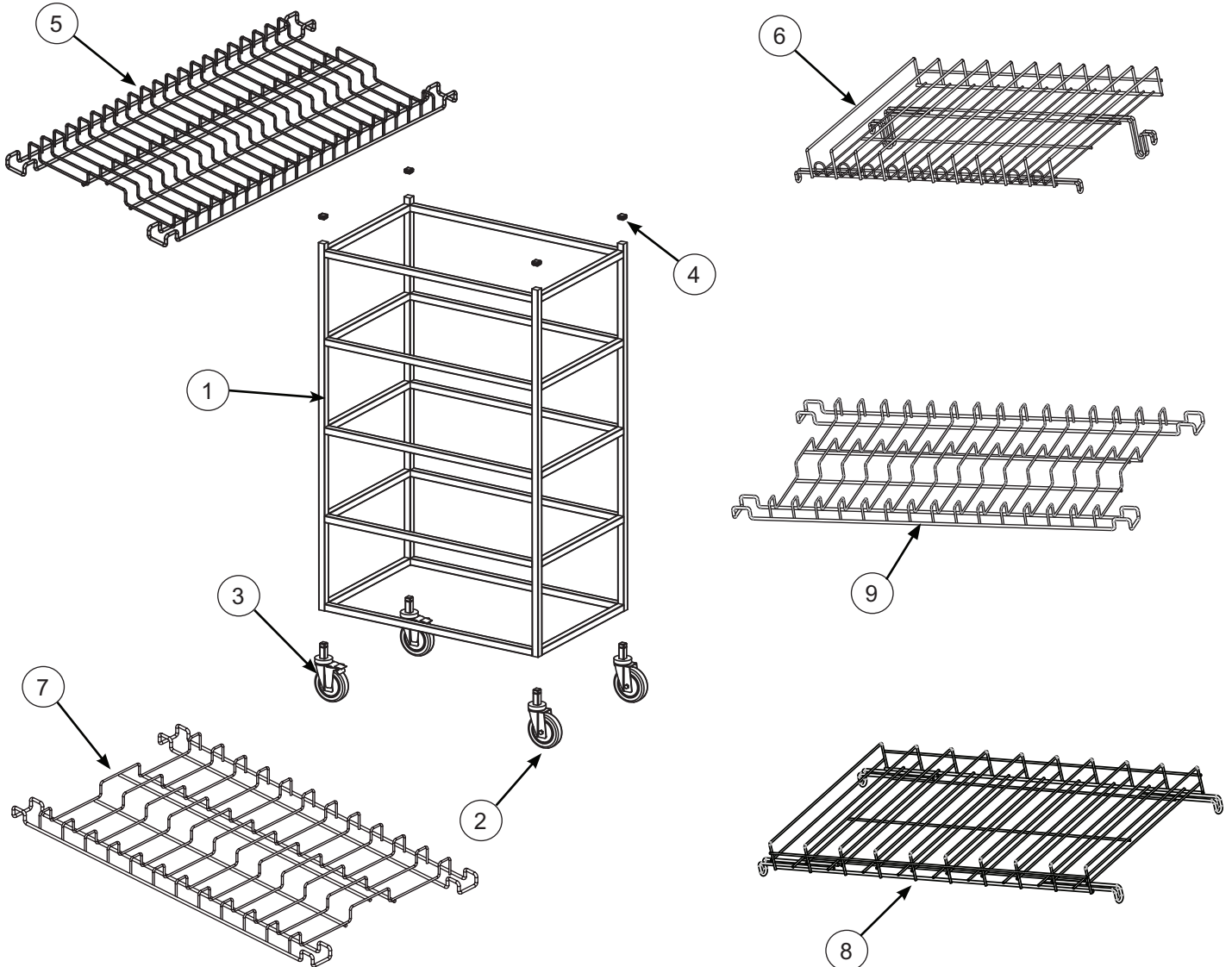

VI . WARRANTY & LIABILITY

ALADDIN TEMP-RITE®
EQUIPMENT
LIMITED WARRANTY

Aladdin Temp-Rite® (“ATR”) warrants to the original purchaser that the equipment listed below shall be free from defects in material and workmanship under normal use for the applicable warranty term set forth below. ATR’s obligation under this warranty is limited to the repair or replacement, at the sole option of ATR, of any part which upon inspection and examination by ATR or its authorized agent is found to be defective. A written description detailing the nature of the claimed defect, together with the equipment claimed to be defective if required by ATR, must be delivered to ATR or its authorized agent within 30 days of discovery of the claimed defect (but in no event later than 30 days after the expiration of the applicable warranty term).

EQUIPMENT	WARRANTY TERM*	
	PARTS	LABOR
DR160E	1 Year	90 Days
DRXLR	1 Year	90 Days
DR88ET	1 Year	90 Days
DR108S	1 Year	90 Days
DR112ES	1 Year	90 Days
Y104S	1 Year	90 Days

*The warranty term commences 30 days after the date of ATR’s invoice for the equipment.

THE WARRANTIES AND REPRESENTATIONS OF ATR CONTAINED HEREIN ARE EXPRESSLY IN LIEU OF, AND THE BUYER WAIVES, ANY AND ALL OTHER WARRANTIES EXPRESS OR IMPLIED, INCLUDING THE WARRANTIES OF MERCHANTABILITY AND FITNESS FOR A PARTICULAR PURPOSE, AND ANY OTHER REMEDIES AGAINST ATR, WHETHER BASED UPON CONTRACT, NEGLIGENCE, STRICT LIABILITY OR OTHERWISE. ATR SHALL NOT BE LIABLE FOR ANY CONSEQUENTIAL OR INCIDENTAL DAMAGES OR ECONOMIC LOSS OF ANY NATURE (INCLUDING WITHOUT LIMITATION LOSS OF REVENUES AND/OR PROFITS) THAT MAY BE CLAIMED TO RESULT FROM ANY NEGLIGENCE OR BREACH OF WARRANTY OR CONTRACT BY ATR.

Exceptions and Exclusions

This warranty is issued only to the original purchaser, and is not transferable and applies only to the products installed within the United States of America, its territories and Canada. During the term of any labor warranty, ATR will pay all pre-approved shipping charges incurred in returning defective equipment to ATR and labor costs incurred in the removal and reinstallation of such equipment. Contact ATR before returning any defective equipment or otherwise performing any warranty repairs. ATR assumes no liability for any work or repair performed without its prior approval. After the expiration of any labor warranty, the original purchaser is responsible for all shipping charges incurred in returning defective equipment to ATR and labor for removing and reinstalling such equipment. ATR shall not be responsible for the replacement of expendable items like lamps and fuses or product failure resulting from normal wear and tear, improper installation, misuse, sabotage, abuse, neglect, accident, unauthorized alterations to repair, or other factors beyond the control of ATR. Neither this warranty, nor the liability of ATR may be modified or extended by action of any agent, distributor or other person or by custom or practice.

CALL ATR TOLL FREE AT 1-800-888-5426 IF YOU HAVE ANY QUESTIONS ABOUT THIS WARRANTY OR YOUR ATR PRODUCT.