

**801397**

801397



## Table of contents

---

Basic unit KINLEY (377443)	3
Refrigeration KINLEY (377444)	5
Module glass door system KINLEY (377445)	7
Electrics KINLEY (377446)	9

# Basic unit KINLEY (377443)

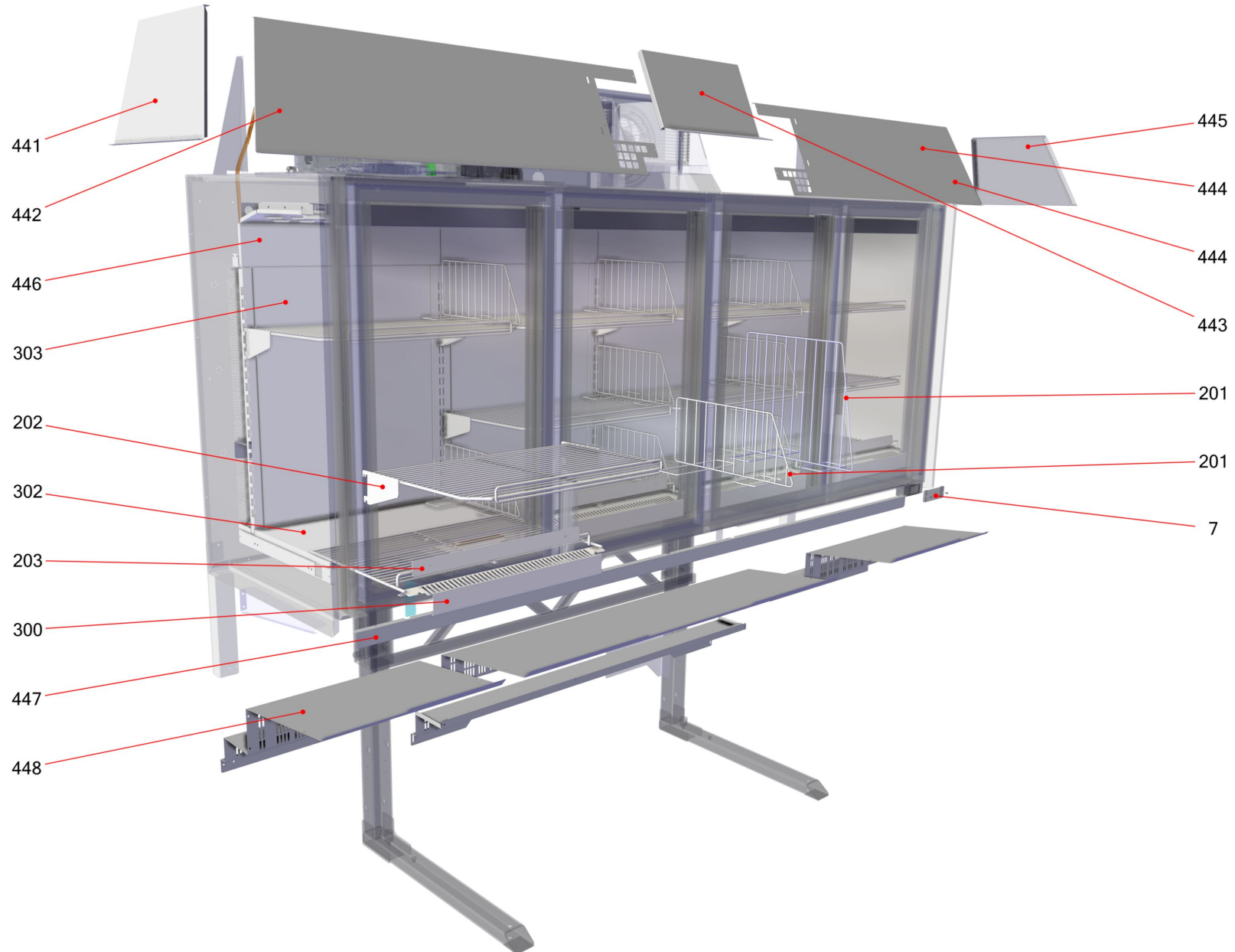

## Basic unit KINLEY (377443)

Item no.	Article no.	Description	Quantity	Unit
202	373070	hanging grid Kinley 210 1,5 white9003	6	ST
203	354128	bottom grid Kinley 210 XL 1,5 white9003	3	ST
300	377038	air plate Kinley210XL white9003	3	ST
302	462687	bottom insert Kinley white9004	3	ST
303	441756	back wall Kinley 210 XL white9004	3	ST
441	376875	cover aggregate KinleyXL left grey7044	1	ST
442	376878	cover aggregate Kinley210XL front left grey7044	1	ST
443	376879	cover condenser KinleyXL grey7044	1	ST
444	376877	cover aggregate Kinley210XL front right grey7044	1	ST
445	376876	cover aggregate Kinley XL right grey7044	1	ST
446	354034	cover plate Kinley210XL G3,5 white9003	1	ST
447	341488	price marking rail L Kinley 210 white9003	1	ST
447	376895	price marking Kinley210XL grey7044	1	ST
448	377479	cover below right Kinley XL 210 G4.1 grey7044	1	ST
448	377482	cover below left Kinley XL 210 G4.1 grey7044	1	ST
448	377485	cover top Kinley XL 210 G4.1 grey7044	2	ST
449	377461	sidewall wedge right KinleyXL grey7044 G4.1	1	ST
449	377462	sidewall wedge left KinleyXL G4.1 grey7044	1	ST

# Refrigeration KINLEY (377444)

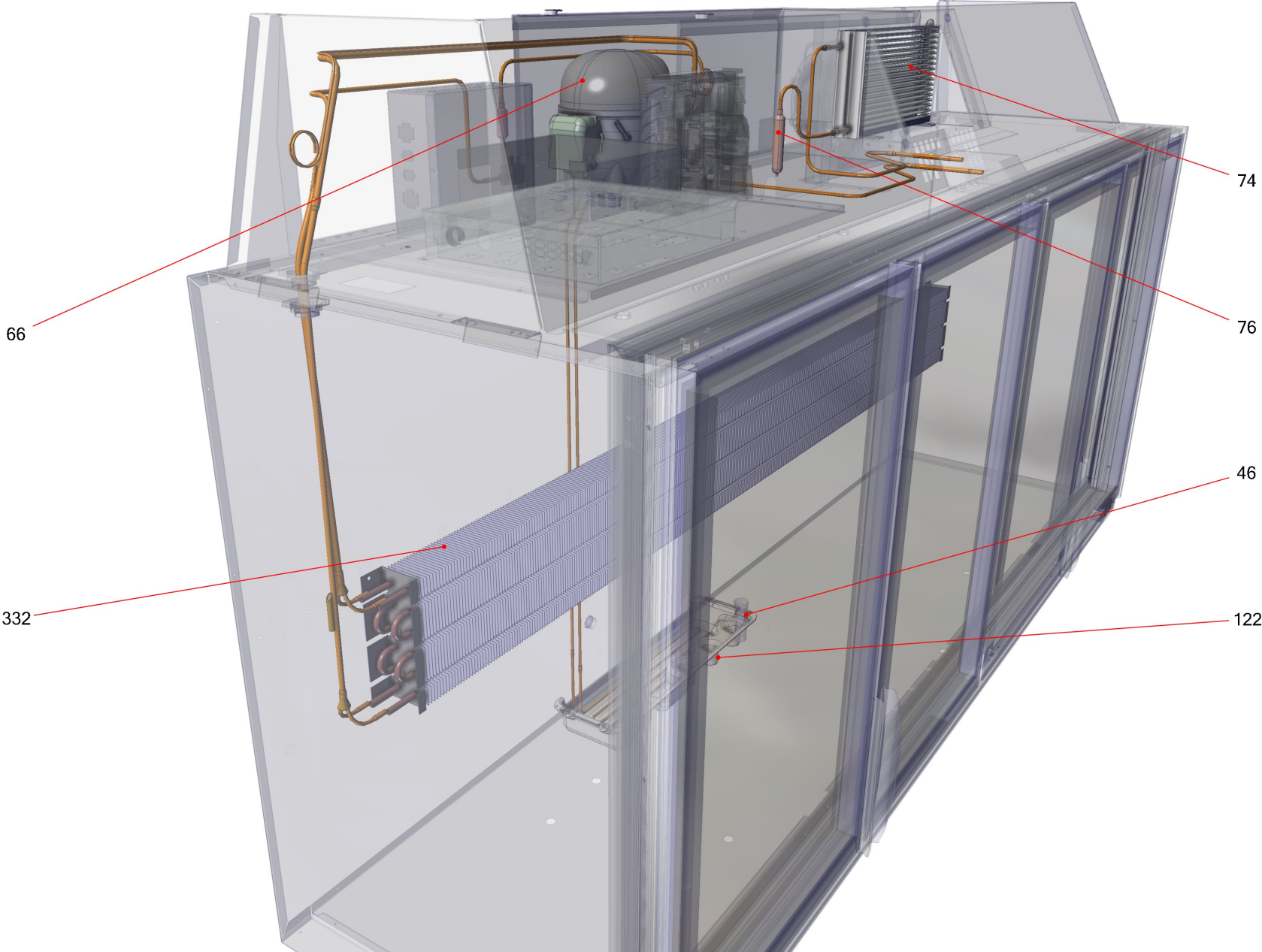

## Refrigeration KINLEY (377444)

Item no.	Article no.	Description	Quantity	Unit
46	355843	interlocking TKL 175+pane white9003	2	ST
66	<a href="#">373529</a>	compressor Secop NLV12.6CN 105H6355	1	ST
74	353505	condenser Kinley HX-L220-00-AHT033	1	ST
76	441536	FILTERTROCKNER 6,1/2,7 12,5G	1	ST
122	377261	evaporator box Kinley XL	1	ST
332	353729	evaporator Sest Kinley210	1	ST

## Module glass door system KINLEY (377445)

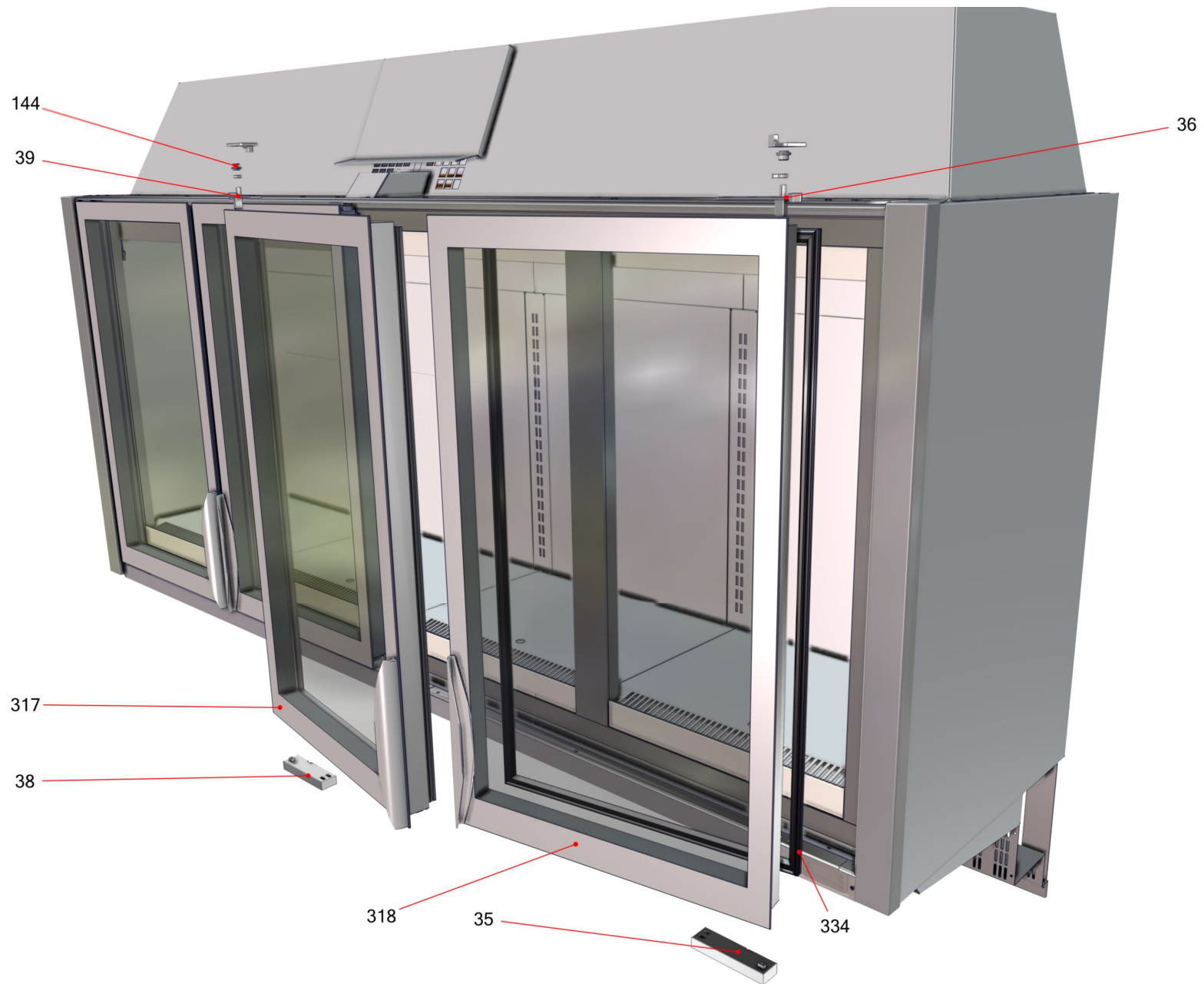

## Module glass door system KINLEY (377445)

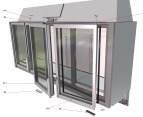
Item no.	Article no.	Description	Quantity	Unit	Picture
318	377447	glass door right Kinley210XL Valentini Edh	3	ST	
334	<a href="#">373982</a>	door seal le/ri Kinley210 Valentini	1	ST	

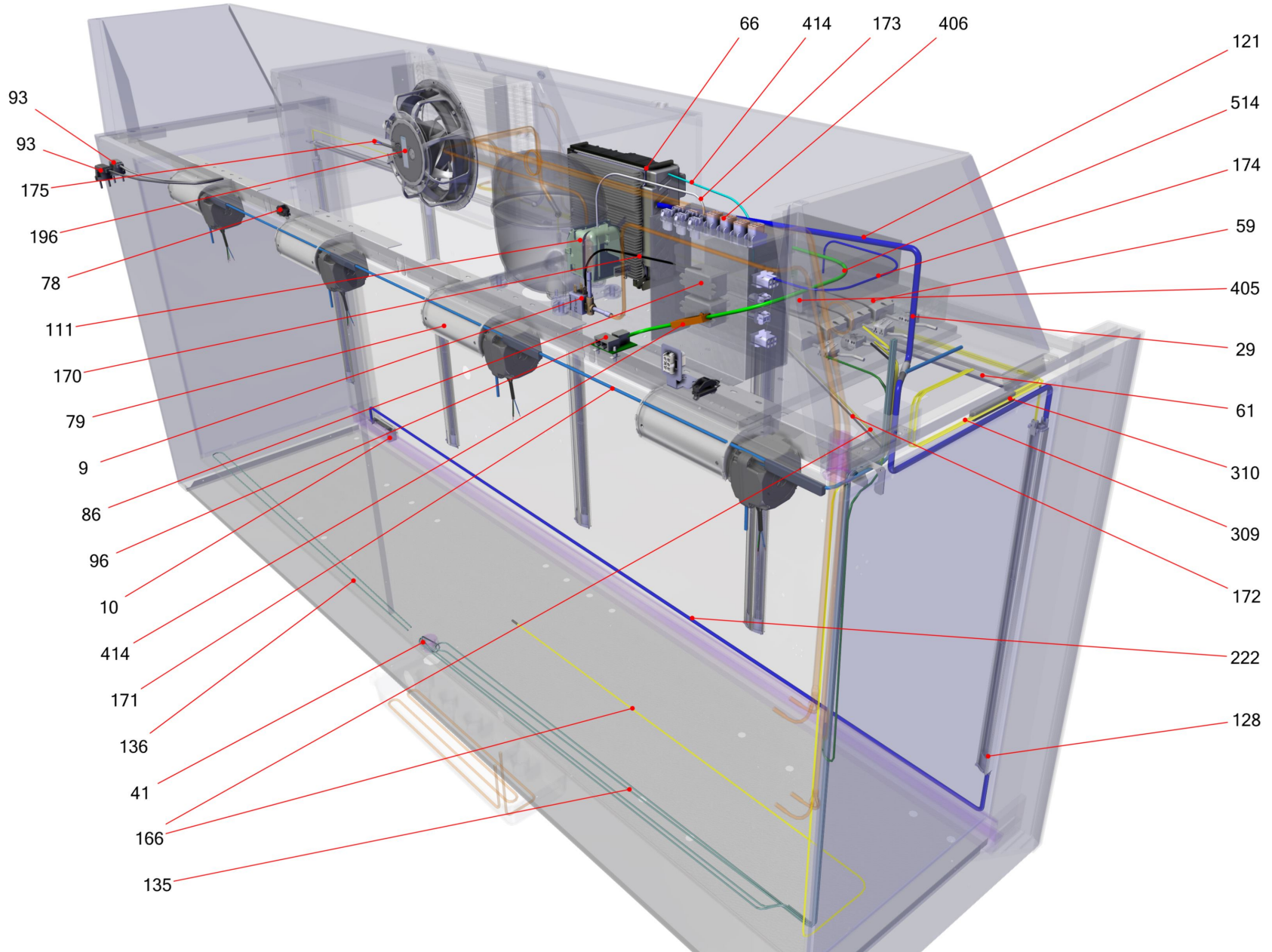

## Electrics KINLEY (377446)

Item no.	Article no.	Description	Quantity	Unit
7	404154	display Secop mekop. Kinley grey7045	1	ST
9	377452	magnet valve Kinley XL EVR6/BY120CS NLV	1	ST
29	206286	clip 2pole Desgson DG238-10.0	4	ST
41	356856	electrical heating water drain Kinley210	1	ST
59	343541	LED driver SAPS Kinley SLT30-24VF-UN	4	ST
61	<a href="#">354000</a>	LED tube SAPS Kinley 900mm 24V 14W 6500K	2	ST
78	22503	strain relief clip 10/2950-00.00-70.81.00	2	ST
79	377448	fan cross current QLZ06/1800-iQ3608 120V	3	ST
80	442365	LÜFTER DIAG. EBM TYP.K1G200-AA84-24 SP	1	ST
93	335196	connection cable IEC UL 5-15P device+barcode	1	ST
93	<a href="#">373377</a>	connection cable IEC US C5 light+barcode	1	ST
96	203705	bus board Secop GP	1	ST
128	343544	LED tube SAPS Kinley 720mm 24V5,5W 6500K	6	ST
135	377449	drain gutter Kinley210XL left	1	ST
136	377450	drain gutter Kinley210XL right	1	ST
163	<a href="#">334120</a>	switch Everel R290 SXL532A1H200W	1	ST
166	376831	sensor temperature Kinley250XL air out GP UL Nam	1	ST
166	376832	sensor temperature Kinley250XL air in GP UL Nam	1	ST
166	376833	sensor limit Kinley GP UL Nam	1	ST
170	377744	cable magnet valve Murr Kinley UL GP	1	ST
171	376852	cable evaporator fan Kinley210XL UL GP NAM	1	ST
172	342059	cable temperature switch Kinley	1	ST

**Electrics KINLEY (377446)**

Item no.	Article no.	Description	Quantity	Unit
174	376828	connection cable electronic box-GP Kinley XL Nam	1	ST
175	376826	cable condenser fan Kinley UL GP Nam	1	ST
222	381086	display cable Kinley XL 250	1	ST
222	390600	cable display + plug in Kinley	1	ST
309	365090	LED distributor SAPS Kinley210XL short	1	ST
310	365091	LED distributor SAPS Kinley210XL long	1	ST
400	408358	LED cable saps Kinley 210 XL 2650mm	1	ST
405	424032	controller NLV/GP 110-240V 50/60Hz 4668	1	ST
406	376823	electronic box Kinley GP UL Nam	1	ST
414	381076	bus line Cat5 0,5m	1	ST