

Operation Manual

Toaster Grills Models 247SL & 248SL

Product Identification

The Prince Castle 247SL & 248SL Toaster Grill Series offers two practical options for quick-and-easy bread product toasting. Both models have pivoting sides allowing for easy access to the platens for cleaning. The 248SL Model has the added feature of a Club sandwich level.

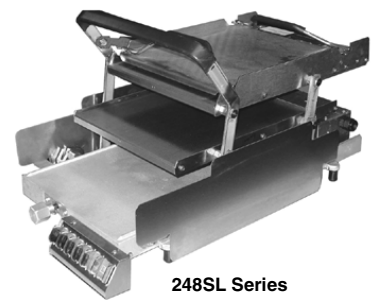

LIMITED WARRANTY

This product is warranted to be free from defects in material and/or workmanship for a period of 1 year from date of original installation, not to exceed 18 months from the date of manufacture.

Any component which proves to be faulty in material and/or workmanship will be replaced or repaired (at the option of Prince Castle, Inc.) without cost to the customer for parts and labor.

This warranty covers on-location service (i.e. trip charges and/or mileage). Travel mileage is limited to 100 miles (200 Kilometers) round trip (one trip warranty) from an authorized service agency or its sub-service agency.

This warranty is subject to the following exceptions/conditions:

- Use of any non-genuine Prince Castle parts voids this warranty.
- All labor to be performed during regular work hours. Overtime premium (the incremental amount) will be charged to the customer.
- Damage caused by carelessness, neglect and/or abuse (e.g., dropping, tampering or altering parts, equipment damaged in shipment, by fire, flood or an act of God) is not covered under this warranty.
- All problems due to operation at voltages other than that specified on equipment nameplates are not covered by this warranty. Conversion to correct voltage is the customer's responsibility.
- This equipment must be serviced by Prince Castle Authorized Service Agency or a Prince Castle Service Technician during the warranty period.



PRINCE CASTLE INC. 
WORLDWIDE

355 East Kehoe Blvd. • Carol Stream, IL 60188 USA
Telephone: 630-462-8800 • Toll Free: 1-800-PCASTLE
Fax: 630-462-1460 • www.princecastle.com

Table of Contents

Product Identification 1
 Safety Information 2
 Accessories 2
 Installation 3
 Setting the Controls 3
 View/Change Set Temperature 5
 View/Change Set Toasting Time 6
 View/Change Duty Time Alarm 8
 Standby (Energy Saving) Mode 8
 View/Calibrate Platen Temperature 9
 Change Product Name (Product Mode Only) 11
 Set Volume Levels (All Models) 11
 Adjusting Bun Crush Settings 12
 Adjusting for Bun Thickness 12
 Conditioning the Platens 13
 Cleaning 14
 Troubleshooting Guide 15
 Ordering Parts and Service 16
 Model 247SL Exploded View 17
 Model 248SL Exploded View 18
 Model 247SL Wiring Diagram 19
 Model 248SL Wiring Diagram 20

Safety Information

 **WARNING**

Indicates information important to the proper operation of the unit. Failure to observe may result in damage to the equipment and/or severe bodily injury or death.

 **CAUTION**

Indicates information important to the operation of the unit. Failure to observe may result in damage to the equipment.

Accessories

Use standard full-size spatulas with the 247SL or 248SL Toaster Grills. Also, use the full-size plastic or metal trays under the bottom Platen. You may also use the new nine-bun trays as they become available.

Important!

Prince Castle reserves the right to change specifications and product design without notice. Such revisions do not entitle the buyer to corresponding changes, improvements, additions or replacements for previously purchased equipment.

Installation

Remove the unit from the carton and inspect for signs of damage. If there is damage to the unit:

- Notify the carrier within 24 hours of delivery.
- Save carton and packaging materials for inspection purposes.
- Contact your local dealer, or if purchased directly, the Prince Castle Sales Department at 1-800-722-7853 or 630-462-8800 to arrange for a replacement unit.

Before first use, clean and condition the platens (see Conditioning Platens).

NOTE: When using this unit, the ambient temperature at the mounting site should not exceed 43°C (110°F).



CAUTION

All electrical connections must be in accordance with local electrical codes and any other applicable codes.

Plug the unit into an applicable electrical receptacle.

Setting the Controls

The model 247SL & 248SL Toaster Grills provide two modes of operation: **DEDICATED MODE** and **PRODUCT MODE**.

- **DEDICATED MODE** is a simple mode of operation for toasting buns, with a set toast time and temperature for one product "BUN1".
- **PRODUCT MODE** allows you to set both the toasting time and temperature individually for four additional products. Note that it may take several minutes for the platen to heat up or cool down to a new temperature setting. You can also change the display to any four character name of your choice for each of the products to indicate which product is being toasted.
- Furthermore, 247SL and 248SL Toaster Grills allow you to manually initiate the power-saving mode. (See **Figure 1**.)

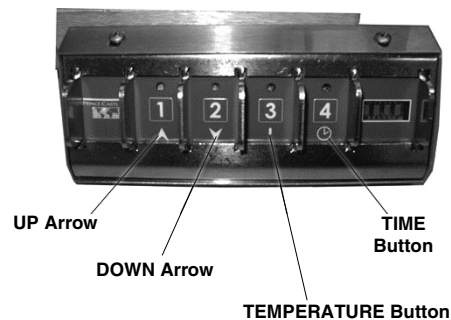

Figure 1

1 When the Toaster Grill is in **Dedicated Mode**:
Press and release both the **UP** and **DOWN** arrows at the same time. This will change the Toaster Grill to Product Mode. Products 1 through 4 will be available.

2 When the Toaster Grill is in **Product Mode**:
Press and release both the **UP** and **DOWN** arrows at the same time. This will change the Toaster Grill to Dedicated Mode. BUN1 will be the only product available.

NOTE: While the unit is adjusting to the new set temperature, the product name flashes in the display. In the Dedicated Mode this is "BUN1". In the Product Mode, the name will be the currently selected product.

When the unit reaches set temperature, the product's name is displayed steadily in Product Mode, or the display shows "RDY" in Dedicated Mode.

The adjustment time necessary will depend on the set temperature.

Product Selection (Product Mode Only)

Press and release any of the four numbered buttons (i.e., 1, 2, 3 or 4) to select the product associated with that button. (See **Figure 2**.)

The LED above the selected Product button glows steady green to indicate the current selection and the display will show the selected product's name.

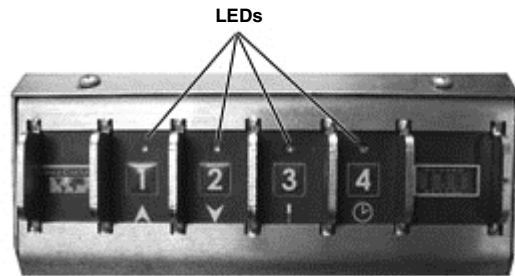

Figure 2

Ready-to-Toast Indication

While the unit is warming up, a product name flashes in the display. In the Dedicated Mode this is "BUN1". In the Product Mode, the name will be the currently selected product. (See **Figure 3**.)

When the unit reaches set temperature, the product's name is displayed steadily in Product Mode, or the display shows "RDY" in Dedicated Mode.

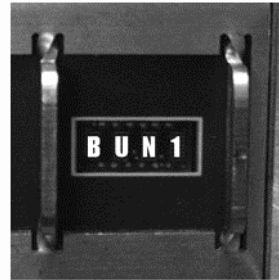

Figure 3

Temperature Mode (F/C) Display Selection

TEMPERATURE MODE: To toggle between Fahrenheit (F) and Celsius (C), at power-on immediately press and release button 3 within 3 seconds. (See **Figure 4**.)

If the unit was set to display temperatures in "C", it changes to display in "F", and vice versa. The display shows "F" or "C" to indicate which mode has been selected. Repeat within 3 seconds to change the display again.

The default Temperature Mode is Celsius.



Press Button 3

Figure 4

Resetting to Factory Presets

To reset all settings to factory presets, at power-on immediately (within 3 seconds) press and hold the **LOGO**, **UP** and **DOWN** buttons simultaneously until the display shows "PSET". Release all buttons. After about 10 seconds, the unit will operate with factory preset temperature, time and display name values. (See **Figure 5**.)

All previously saved settings are lost upon resetting the defaults.

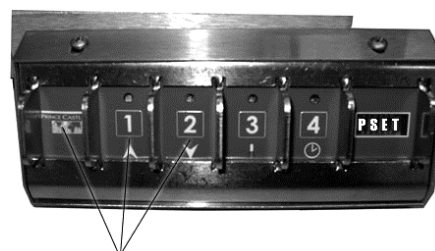

Press These Buttons
at the Same Time

Figure 5

View/Change Set Temperature

To View the Current Set Temperature

In Product Mode:

Press and hold the currently selected product's button and immediately press the **TEMPERATURE** button. Release both buttons.

The display will show the pre-set toasting temperature for the selected product. (See **Figure 6**.)

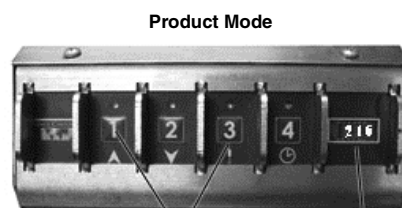

Press PRODUCT Button and
TEMPERATURE Button

Product's Set
Temperature Is
Displayed

Figure 6

In Dedicated Mode:

Press and release the **TEMPERATURE** button. The display will show the pre-set toasting temperature for "BUN1". (See **Figure 7**.)



Press TEMPERATURE
Button

Display Shows BUN1
Set Temperature

Figure 7

To Change the Set Temperature

1 Press the button(s) used to view the set temperature. Hold the button(s) for 6 seconds.
The LED above the **TEMPERATURE** button will flash yellow, indicating that the unit is now in set-temperature programming mode. Release all buttons.

2 Press and release the **UP** or **DOWN** buttons to change the currently selected product's toasting temperature. Holding either button for 3 seconds will allow automatic "fast scrolling" for easier programming.
The temperature can be set from 37°C to 287°C (100°F to 550°F).

NOTE: While the unit is adjusting to the new set temperature, the product name flashes in the display. In the Dedicated Mode this is "BUN1". In the Product Mode, the name will be the currently selected product.
When the unit reaches set temperature, the product's name is displayed steadily in Product Mode, or the display shows "RDY" in Dedicated Mode.
The adjustment time necessary will depend on the set temperature.

3 When finished, press and release the **TIME** button to save the new value and return to toasting.
Press and release the **LOGO** button at any time to exit the programming mode without saving any changes made.

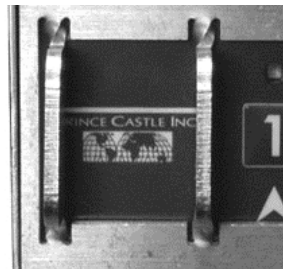

LOGO Button

Figure 8

View/Change Set Toasting Time

To View the Set Toasting Time

In Product Mode:
Press and hold the currently selected product's button and immediately press the **TIME** button. Release both buttons. The display will show the present toasting time for the selected product. (See Figure 9.)

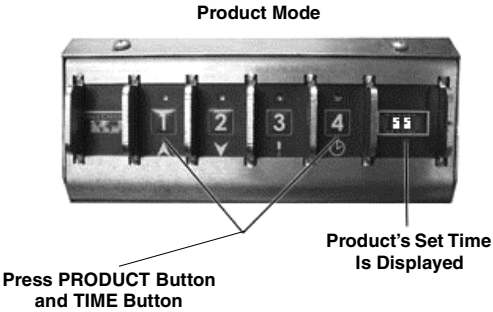

Figure 9

In Dedicated Mode:

Press and release the **TIME** button. The display will show the present toasting time for "BUN1".

In either mode, after 3 seconds the display will return to showing the currently selected product time. (See **Figure 10**.)

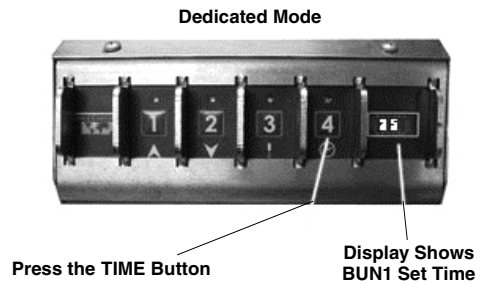

Figure 10

To Change the Set Toasting Time

- 1 To change the toasting time of the currently selected product, press the same button(s) used to view the toasting time. Hold the button(s) for 6 seconds.

The LED above the **TIME** button will flash yellow, indicating that the unit is now in set-time programming mode. Release all buttons.

- 2 Press and release the **UP** or **DOWN** buttons to change the currently selected product's toasting time. Holding either button for 3 seconds will allow automatic "fast scrolling" for easier programming.

The time can be set from 1 second to 9 minutes, 59 seconds.

- 3 When finished, press and release the **TIME** button to save the new value and return to toasting.

Press and release the **LOGO** button at any time to exit the programming mode without saving any changes. (See **Figure 11**.)

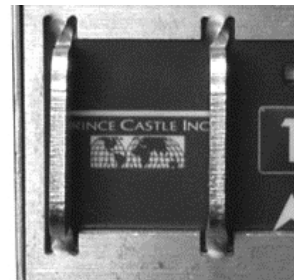

Figure 11

View/Change Duty Time Alarm

- 1 A. Press and hold the **LOGO** button. Immediately press the **TIME** button.
B. Release all buttons. The display will show the present duty time for "BUN1" in **Dedicated Mode** and for whichever product is selected in **Product Mode**.

- 3 Press and release the **UP** or **DOWN** buttons to change the currently selected product's duty time.
When finished, press and release the **TIME** button to save the new value and return to toasting.

- 2 To change the duty time of the currently selected product, press and hold the buttons in Step 1 for 6 seconds.
The LEDs above the **TIME** and **UP** Arrow button will flash yellow, indicating that the unit is now in the duty time programming mode.

To exit the programming mode without saving any changes, press and release the **LOGO** button.
NOTE: The duty time may be set to OFF or 15 – 20 seconds. If not off, the duty alarm will sound the programmed number of seconds after toasting is started.

Standby (Energy Saving) Mode

- 1 **Direct Method:** To place the unit in Standby Mode, close the platen and press and hold the **UP** and **DOWN** buttons together for 3 seconds. The unit will stop timing and the display will indicate "STBY". Open the platen to cancel Standby mode. (See **Figure 12**.)

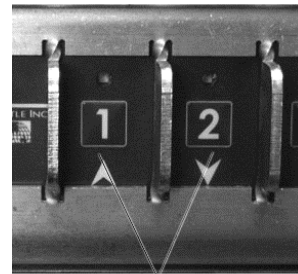

UP and DOWN Arrows

Figure 12

- 2 **After Toasting:** After toasting is complete, the Done Alarm will sound for 7 seconds. If the platen is left closed, the Toaster Grill will automatically enter the Standby Mode and the display will read "STBY". Open the Toaster Grill to reactivate it from Standby Mode. (See **Figure 13**.)

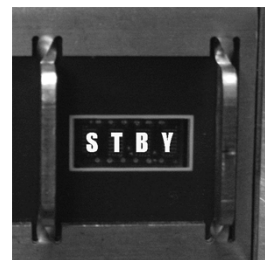

Figure 13

View/Calibrate Platen Temperature

Important!

Do NOT perform this procedure until the Toaster Grill has been on for at least 45 minutes, and the temperature has stabilized. Do NOT use the Toaster Grill during the first 45 minutes.

Temperature can only be adjusted $\pm 10^{\circ}\text{C}$ ($\pm 18^{\circ}\text{F}$) during calibration.

Important!

If the temperature reading from the external temperature port is greater than $\pm 3^{\circ}\text{C}$ ($\pm 5^{\circ}\text{F}$) compared to the Toaster Grill temperature display, proceed with the following. If temperature reading is within $\pm 3^{\circ}\text{C}$ ($\pm 5^{\circ}\text{F}$), the Toaster Grill is functioning properly and does not need calibration.

Upper Platen (248SL Models Only)

- 1 A. Plug an external temperature meter into the external port (Type K mini-jack) of the heater platen.
- B. Using the external temperature meter as a standard, adjust the Toaster Grill's temperature display to match the meter's temperature display by the following procedure.

NOTE: Yellow Type K Thermocouple mini-jack temperature ports are located on the back of the 248SL Model, behind each of the two platens. (See **Figure 14**.)

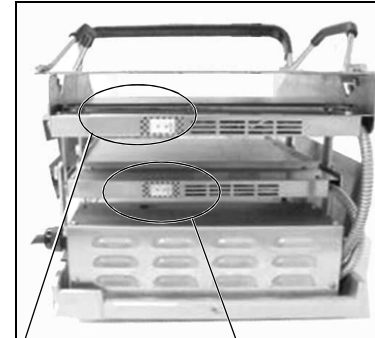

Upper External

Lower External

Figure 14

- 2 A. To view and/or calibrate the platen temperature, press and hold the **LOGO** button.
 - B. Immediately press the **UP** button to view the Upper Platen temperature on 248SL Models.
 - C. Release both buttons. (See **Figure 15**.)
- The display shows the Upper Platen's temperature. After 3 seconds, the display returns to showing the currently selected product.



Press LOGO Button and UP Arrow

Display Shows the Upper Platen Temperature (248SL Only)

Figure 15

Toaster Grills

Models 247SL & 248SL

3 To calibrate the Upper Platen, press and hold the **LOGO** and **UP** buttons, as in Step 2, but continue holding them for 6 seconds.

The LEDs above to buttons **1** & **3** flash, indicating that the unit is now in Upper Platen temperature calibration mode.

Release all buttons.

4 To change the Upper Platen's displayed temperature, press and release button **UP** or **DOWN** Arrow.

After changing the value, be sure to wait for the display to show the temperature change.

5 To save the new value and return to toasting, press and release button **4**.

To exit programming without saving any changes made, press and release the **LOGO** button.

Lower Platen (All Models)

1 A. Plug an external temperature meter into the external port of the heater platen.
B. Using the external temperature meter as a standard, adjust the Toaster Grill's temperature display to match the meter's temperature display, by the following procedure.

2 A. To view the Lower Platen's temperature, press and hold the **LOGO** button.
B. Immediately press the **DOWN** button. Release all buttons.
The display shows the Lower Platen's temperature. After 3 seconds, the display returns to showing the currently selected product. (See **Figure 16**.)



Press **LOGO** Button and **DOWN** Arrow

Display Shows the Lower Platen Temperature

Figure 16

3 To calibrate the Lower Platen, press and hold the **LOGO** button and **DOWN** arrow, as in Step 2, but continue holding them for 6 seconds.

The LEDs above buttons **2** & **3** flash, indicating that the unit is now in Lower Platen temperature calibration mode.

Release all buttons.

NOTE: A yellow temperature port is located on the back of the 247SL Model, behind the platen (same as the Lower External Port in on 248SL Model figure above). (See **Figure 16**.)

4 To change the Lower Platen's displayed temperature, press and release **UP** or **DOWN** arrows.
After changing the value, be sure to wait for the display to show the temperature change.

5 When finished, press and release button **4** to save the new value and return to toasting.
To exit programming without saving any changes made, press and release the **LOGO** button.

Change Product Name (Product Mode Only)

- 1** Place the Toaster Grill in **PRODUCT MODE** (refer to "Mode Selection").
Press one of the four numbered buttons (i.e., **1**, **2**, **3** or **4**) to select the product name you wish to change.
- 2** Press and hold the **LOGO** button and button **3** for 6 seconds.
The LED next to the currently selected Product flashes and the first character of its displayed name blinks.
- 3** A. Use **UP** or **DOWN** arrows to scroll through the available characters for the display.
B. Hold either button for 3 seconds to allow automatic "fast scrolling" for easier programming.
- 4** When the desired character is displayed in the first position, release the **UP** or **DOWN** arrow, and press and release button **3** to move on to the second display character.
- 5** A. Repeat Steps 3 and 4 to program each character as desired.
B. When in the fourth position, press and release button **3** to return to the first display character.
- 6** When the display name is changed as desired, press and release button **4** to save it.
To exit programming without saving any changes made, press and release the **LOGO** button.

Set Volume Levels (All Models)

- 1** To view the current volume level, press and hold the **LOGO** button. Immediately press and hold the **TIME** button and **TEMPERATURE** button to view the present Volume Level.
Release all buttons.
The display will return to showing the currently selected product.
- 2** To change the volume level, press and hold the buttons in Step 1 for 6 seconds. The display will continue to show Volume Level and a tone will sound indicating that the unit is now in Volume Setting Mode.
- 3** Press and release the **UP** or **DOWN** arrows to adjust the volume level.
When finished, press and release the **TIME** button to save the new value and return to toasting.

Adjusting Bun Crush Settings

To adjust the bun crush settings, use the knob located on the front of the unit's base. There are 10 incremental settings, each increasing the center gap by approximately 2 mm. (See **Figure 17**.)

- To set the thickness from 1 to 5, lift and slide the knob to the left-most position. Then, rotate the knob until the desired setting is in the "window".
- To set the thickness from 6 to 10, lift and slide the knob to the right-most position. Then, rotate the knob, until the desired setting is in the "window".

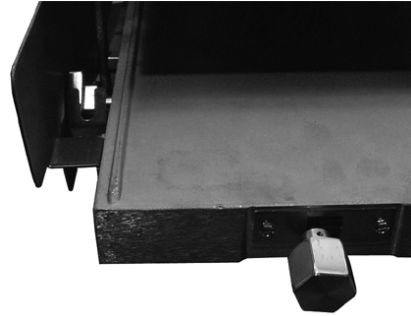

Figure 17

Adjusting for Bun Thickness

The 248SL model has two sets of notches in the side bun fences. (See **Figure 18**.)

- Select the bun board notch to match the bun thickness to achieve the best results (appropriate bun crush).

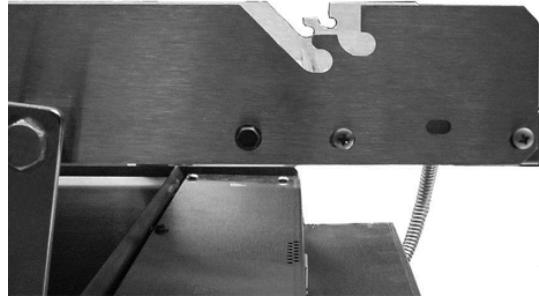

Figure 18

Conditioning the Platens

- 1** To minimize bun-sticking, the platens should be wiped weekly with Toaster Grill Release Agent.

 **CAUTION**

Use only Toaster Grill Release Agent on bun Toaster Grills. Other products may cause damage and void the Warranty.

- A. Dust all loose crumbs from Toaster Grill surfaces.
- B. Apply Toaster Grill Release Agent to cool or warm Toaster Grill platens.

- 2** To coat the platen surface, thoroughly wet a clean, folded customer napkin or paper towel with Toaster Grill Release Agent, and place it on a cleaning tool.

- 3** A. Rub a generous amount of the Release Agent over the entire surface of the platen until well coated.
B. Repeat Steps 2 and 3 for other platens, including undersides.

 **WARNING**

BURN HAZARD! Use protective gloves and a cleaning tool when conditioning hot platens.

IMPORTANT! Do NOT wipe Toaster Grill with a damp cloth after Release Agent is applied. Doing so removes Agent and causes sticking.

Toaster Grill platens must be clean and dry.

- 4** Reapply Release Agent weekly to all platen surfaces while Toaster Grill is cold.
If sticking occurs between weekly applications, reapply Release Agent more frequently as described in Steps 1 – 3.

Cleaning

- 1** A. Periodically and upon shutdown, use a clean, dry soft cloth to wipe down the Toaster Grill unit.
B. When the platens are cool, you may also use a mild soap solution on a damp soft cloth to remove stubborn food remains, if necessary.
Do NOT use any unapproved agents or cleaning solutions inside or on surfaces of Toaster Grill unit. Such misuse could void the warranty.

 **WARNING**

Do Not Clean with Water Jet.

- 2** Remove the side covers, as shown, for further cleaning. (See **Figure 19**.)

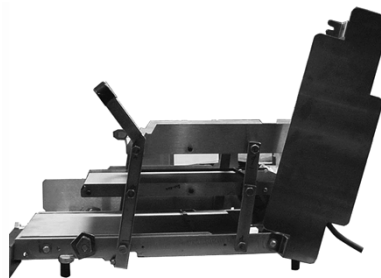

Figure 19

- 3** Replace side covers when finished. (See **Figure 20**.)

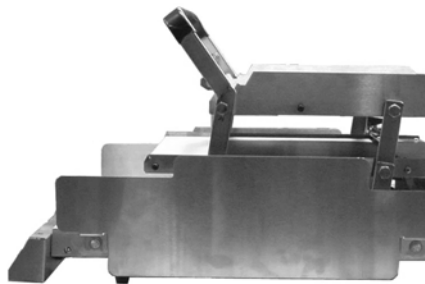



Figure 20

Troubleshooting Guide

 **WARNING**

SHOCK HAZARD! Live circuits are exposed! Use extreme care during electrical circuit tests. Do NOT attempt any troubleshooting without proper authorization to do so.

 **WARNING**

Inspection, testing and repair of electrical equipment are to be performed by qualified service personnel ONLY. Unplug unit during testing, except as electrical tests are required.

| PROBLEM | PROBABLE CAUSE | SOLUTION |
|--------------------------|---|---|
| Platen loose. | Platen bolts loose. | Tighten platen bolts. |
| No alarm. | Defective timer switch. | Replace timer switch. |
| | Activation magnet is missing. | Two magnets are required. |
| Buns being crushed. | Stop blocks not adjusted properly. | Adjust stop blocks. |
| | Warped bun trays. | Straighten or replace bun trays. |
| | Buns cut improperly. | Contact bakery. |
| | Warped bun board. | Straighten or replace bun board. |
| Platen does not heat. | No power. | Check power source. |
| | Power switch defective. | Replace power switch. |
| | Loose wiring. | Correct as necessary. |
| | Defective temperature probe. | Replace temperature probe. |
| | Platen burned out or shorted. | Replace platen; call Service Agency. |
| Buns sticking to platen. | Excessive heat due to reversed upper and lower temperature probe connections. | Reverse connections of upper and lower temperature probe connections in electrical box. |
| | Build up of sugar on platen. | Clean platen. |
| Cold platen. | Loose electrical connection. | Reconnect wires from solid-state relay to printed circuit boards. |

Ordering Parts and Service

To Order Replacement Parts or Service —

A. **DOMESTIC:** Refer to the back of the Price List for your local Prince Castle Service Center, or call Prince Castle at 1-800-722-7853 for assistance.

B. Call your local Prince Castle Service Center. Fill in name and number here:

C. **INTERNATIONAL:** Contact your kitchen Equipment Supplier or designated repair facility for parts and service.

To Return Parts for Credit —

Should the need ever arise to return parts to your Service Center for credit, it is necessary that you:

A. Obtain authorization from your Service Center;

B. Request Warranty fulfillment from your Service Center

All Prices are F.O.B. Prince Castle Service Center or F.O.B. factory, Carol Stream, Illinois, USA. Prices are subject to change without notice. These prices are exclusive of all sales taxes or any special taxes, which may be levied by federal, state or city governments.

Parts Price Lists are sent to the USA restaurants once a year, and indicate the prices available from your local Service Center.

Terms: Net 30 days.

Exploded Views

Parts Breakdown

| No. | Part No. | Description |
|-----|----------|-----------------------------------|
| 1 | 248-141S | Overlay Kit |
| 2 | 248-140S | Display Printed Circuit Board Kit |
| 3 | 66-017S | Strain Relief Kit |
| 4 | 248-151S | Stop Block Kit |
| 5 | 411-149S | Front Lever Kit * |
| 6 | 411-60S | Lower Platen Stud (Pkg. of 2) |
| 7 | 411-113S | Base Spacer (Pkg. of 7) |
| 9 | 248-018S | Lower Platen Fence Kit, RH & LH * |
| 10 | 411-461S | Rear Upper Lever Assembly * |
| 11 | 411-459S | Rear Lower Lever Assembly |
| 12 | 248-044S | Side Panel Kit, LH * |
| 13 | 248-109S | Side Panel Kit, RH * |
| 14 | 65-058S | Relay |
| 15 | 66-045S | Strain Relief |
| 16 | 78-196S | Switch Kit |
| 17 | 411-61S | Lower Platen Stud (Pkg. of 2) * |
| 18 | 411-57S | Platen Spacer (Pkg. of 2) * |
| 19 | 411-221S | Spacer Kit (Pkg. of 4) |
| 20 | 248-099S | Base Spacer Kit (Pkg. of 2) * |
| 21 | 411-147S | Upper Platen Stud (Pkg. of 2) |

* Not shown.

| No. | Part No. | Description |
|-----|----------|-------------------------------------|
| 22 | 248-048S | Safety Latch Kit * |
| 23 | 248-114S | Knob Kit |
| 24 | 248-045S | Rear Bun Fence Kit |
| 25 | 72-416S | Power Cord Kit - 247-A & 248-B |
| 26 | 88-497S | Mini Jack, Type K |
| 27 | 89-959S | Rubber Foot (Pkg. of 4) |
| 28 | 248-095S | Temperature Probe |
| 29 | 248-038S | Bun Board for 248 * |
| 30 | 248-079S | Reed Switch Kit |
| 31 | 248-067S | Main Printed Circuit Board Assembly |
| 32 | 248-111S | Upper Bun Fences Kit * |
| 33 | 248-090S | Lower Platen Kit |
| 34 | 248-091S | Upper Platen Kit * |
| 35 | 247-006S | LH Bun Fence Assembly |
| 36 | 247-004S | RH Bun Fence Assembly |
| 37 | 411-347S | Replacement Stud Kit |
| 38 | 247-001 | Safety Latch Kit |
| 39 | 247-032S | Front Lever Assembly for 247 |
| 40 | 411-241S | Safety Latch Spacer (Pkg. of 2) |
| 41 | 247-014S | Bun Board |

* Not shown.

Model 247SL

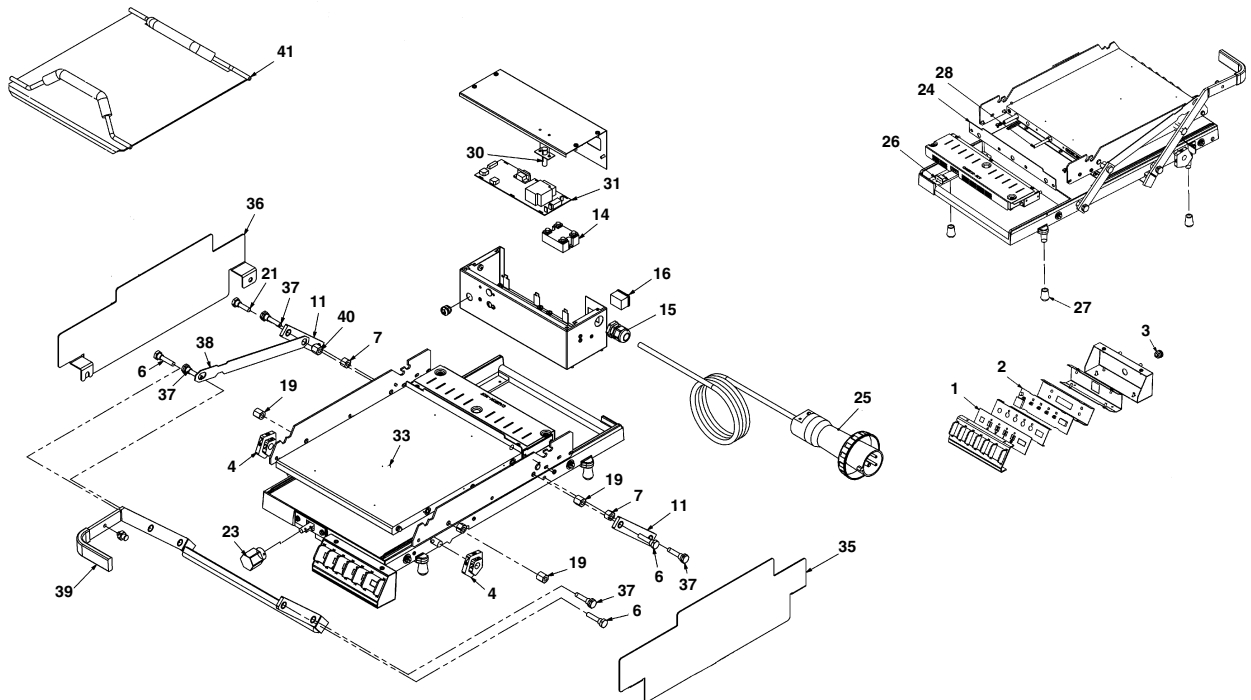

Parts Breakdown

| No. | Part No. | Description |
|-----|----------|-----------------------------------|
| 1 | 248-141S | Overlay Kit |
| 2 | 248-140S | Display Printed Circuit Board Kit |
| 3 | 66-017S | Strain Relief Kit |
| 4 | 248-151S | Stop Block Kit |
| 5 | 411-149S | Front Lever Kit * |
| 6 | 411-60S | Lower Platen Stud (Pkg. of 2) |
| 7 | 411-113S | Base Spacer (Pkg. of 7) |
| 9 | 248-018S | Lower Platen Fence Kit, RH & LH |
| 10 | 411-461S | Rear Upper Lever Assembly |
| 11 | 411-459S | Rear Lower Lever Assembly |
| 12 | 248-044S | Side Panel Kit, LH |
| 13 | 248-109S | Side Panel Kit, RH |
| 14 | 65-058S | Relay |
| 15 | 66-045S | Strain Relief |
| 16 | 78-196S | Switch Kit |
| 17 | 411-61S | Lower Platen Stud (Pkg. of 2) |
| 18 | 411-57S | Platen Spacer (Pkg. of 2) |
| 19 | 411-221S | Spacer Kit (Pkg. of 4) |
| 20 | 248-099S | Base Spacer Kit (Pkg. of 2) * |
| 21 | 411-147S | Upper Platen Stud (Pkg. of 2) |

* Not shown.

| No. | Part No. | Description |
|-----|----------|-------------------------------------|
| 22 | 248-048S | Safety Latch Kit |
| 23 | 248-114S | Knob Kit |
| 24 | 248-045S | Rear Bun Fence Kit |
| 25 | 72-416S | Power Cord Kit – 247-A & 248-B |
| 26 | 88-497S | Mini Jack, Type K |
| 27 | 89-959S | Rubber Foot (Pkg. of 4) |
| 28 | 248-095S | Temperature Probe |
| 29 | 248-038S | Bun Board for 248 |
| 30 | 248-079S | Reed Switch Kit |
| 31 | 248-067S | Main Printed Circuit Board Assembly |
| 32 | 248-111S | Upper Bun Fences Kit |
| 33 | 248-090S | Lower Platen Kit |
| 34 | 248-091S | Upper Platen Kit |
| 35 | 247-006S | LH Bun Fence Assembly * |
| 36 | 247-004S | RH Bun Fence Assembly * |
| 37 | 411-347S | Replacement Stud Kit * |
| 38 | 247-001 | Safety Latch Kit * |
| 39 | 247-032S | Front Lever Assembly for 247 * |
| 40 | 411-241S | Safety Latch Spacer (Pkg. of 2) * |
| 41 | 247-014S | Bun Board * |
| 42 | 411-149S | Front Lever Assembly for 248 |

* Not shown.

Model 248SL

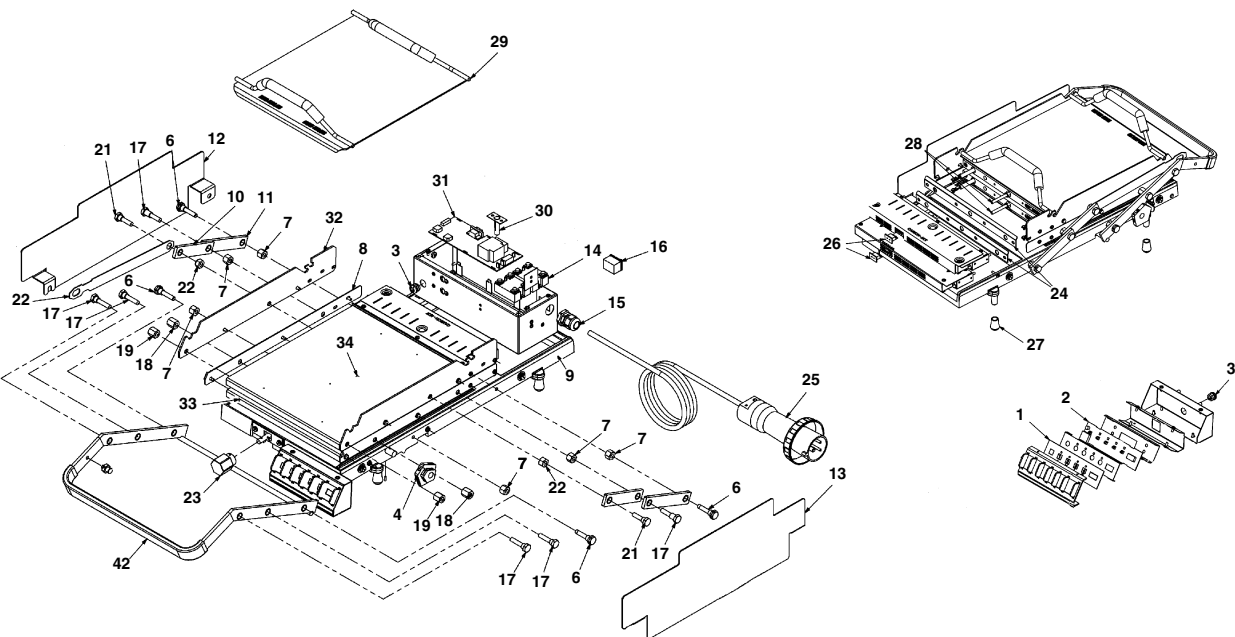

Wiring Diagrams

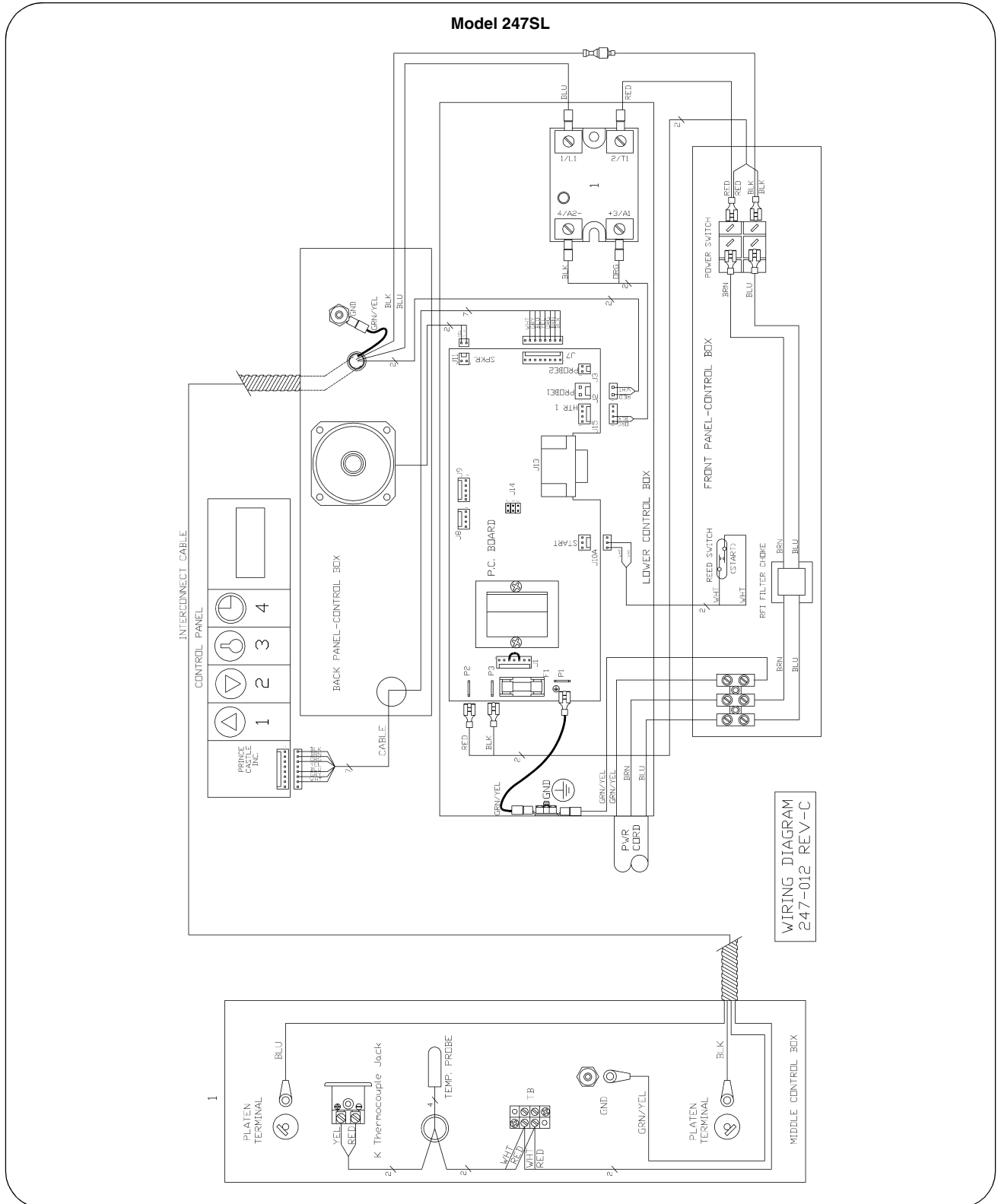

Toaster Grills Models 247SL & 248SL

Model 248SL

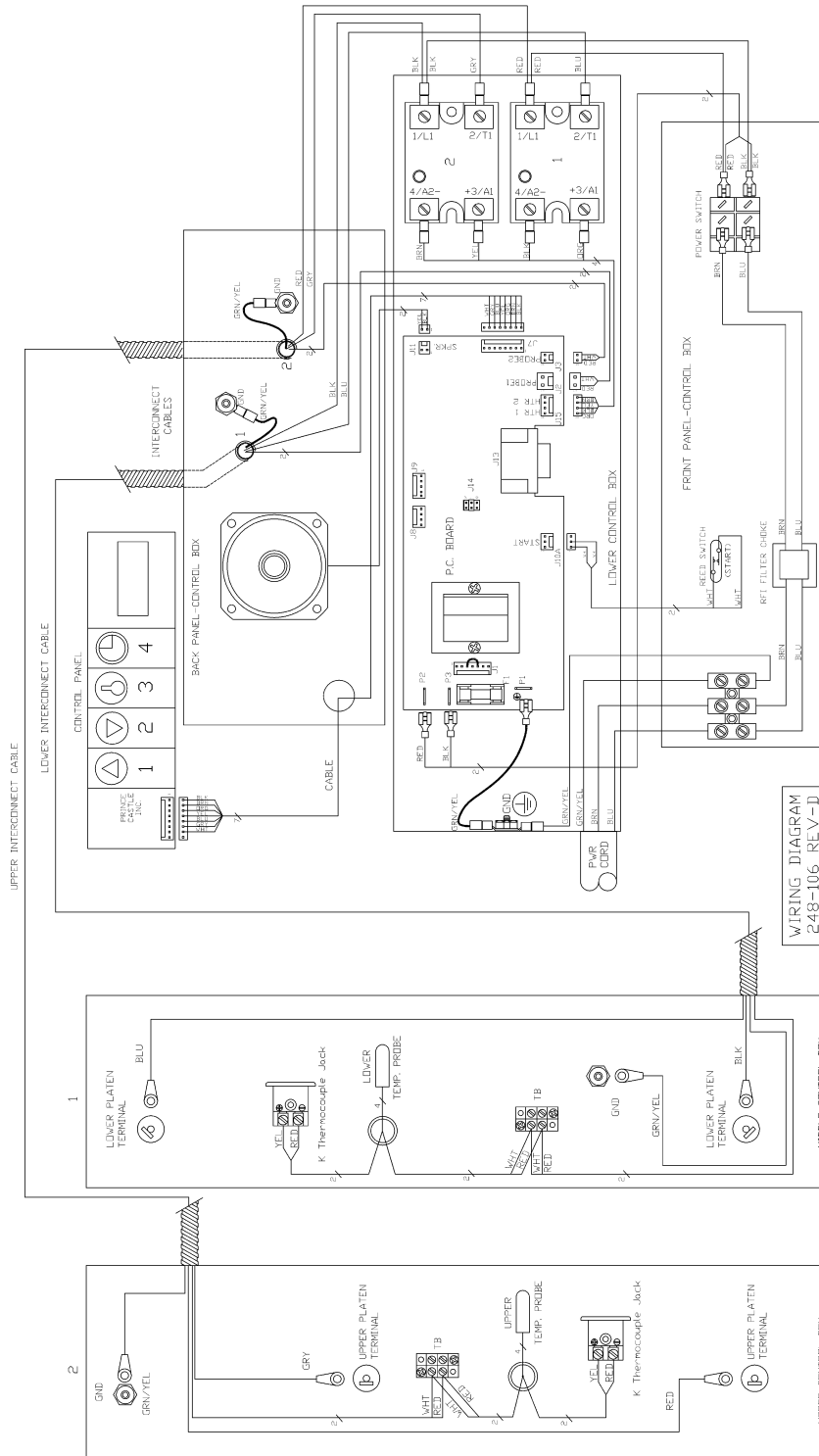

WIRING DIAGRAM
248-106 REV-D