

2478SQ-NA-WM

Parts View

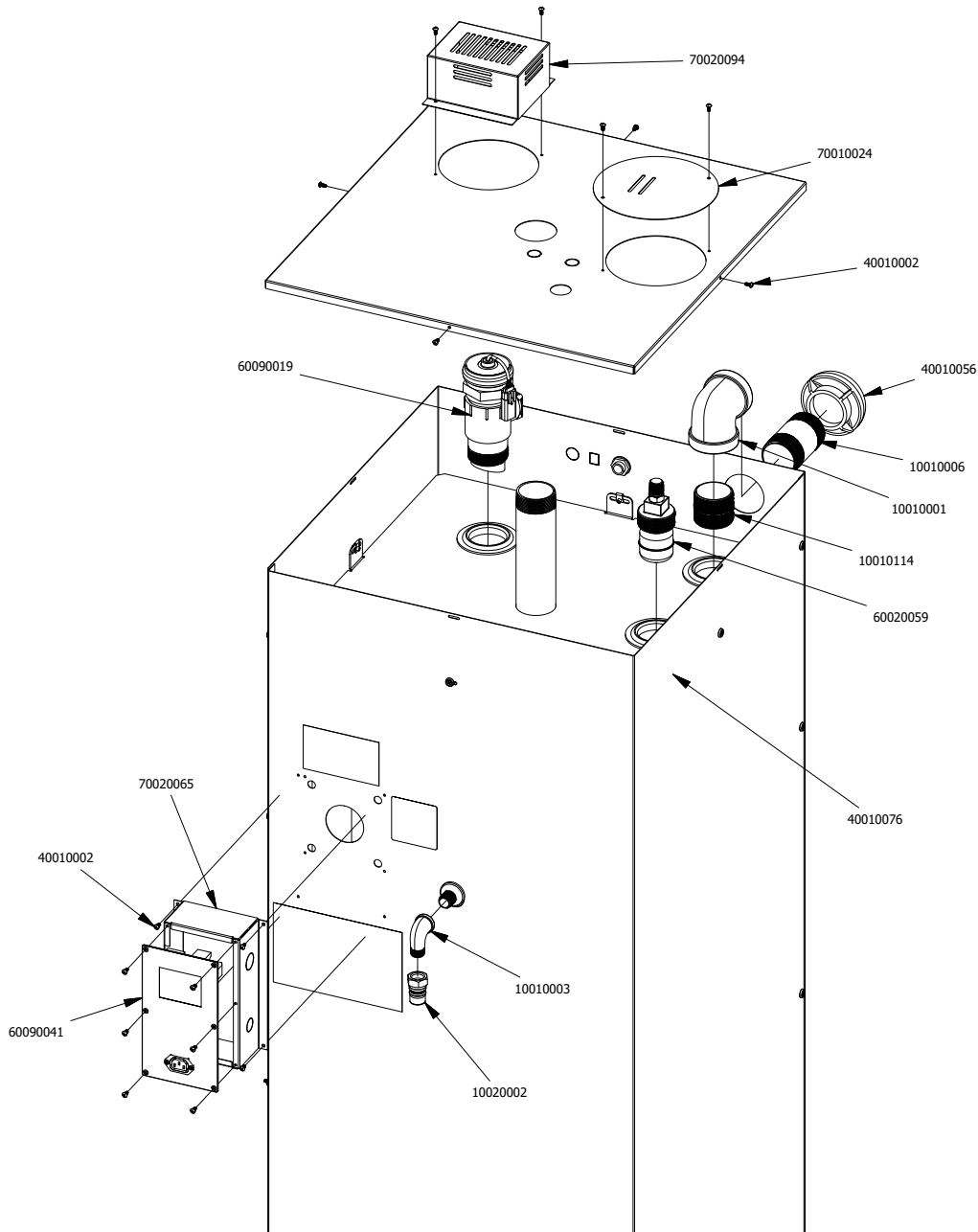

| Part Number | Description | Qty | Part Number | Description | Qty |
|-------------|------------------------------------------|-----|-------------|---------------------------------------------------|-----|
| 10010001 | 2" 90 Deg. Galv. Elbow | 1 | 60090019 | MNU Level Sensor Assembly w/ Standpipe & Fan | 1 |
| 10010006 | 2" x 4" Galv. Nipple | 1 | 60090041 | M3 Gen 3 Control Panel assembled & mounted for NA | 1 |
| 10010114 | 2" x Close Galv. Nipple | 1 | 70010024 | SS Top Inspection Cover | 1 |
| 40010002 | 8-32 X 3/8" Panhead Screw | 10 | 70020094 | Sensor Cover for Indoor Tanks | 1 |
| 40010056 | 2" Tank Vent | 1 | 70020065 | Flat Back Mounting Bracket for M3 Control Panel | 1 |
| 40010076 | Silicone Cap for Mechanical Float Sensor | 1 | 10010003 | 1/2" Galv. Street Elbow | 1 |
| 60020059 | Mechanical Float Sensor | 1 | 10020002 | 1/2" Quick Disconnect Fitting, Nipple, Food Grade | 1 |

FRONTLINE
international
 187 ASCOT PARKWAY
 CUYAHOGA FALLS, OH 44223

TITLE: 2478SQ-NA-WM Parts View
 PART NUMBER: 2478SQ-NA-WM

2/8/24 SHEET 1 OF 3

2478SQ-NA-WM Parts View

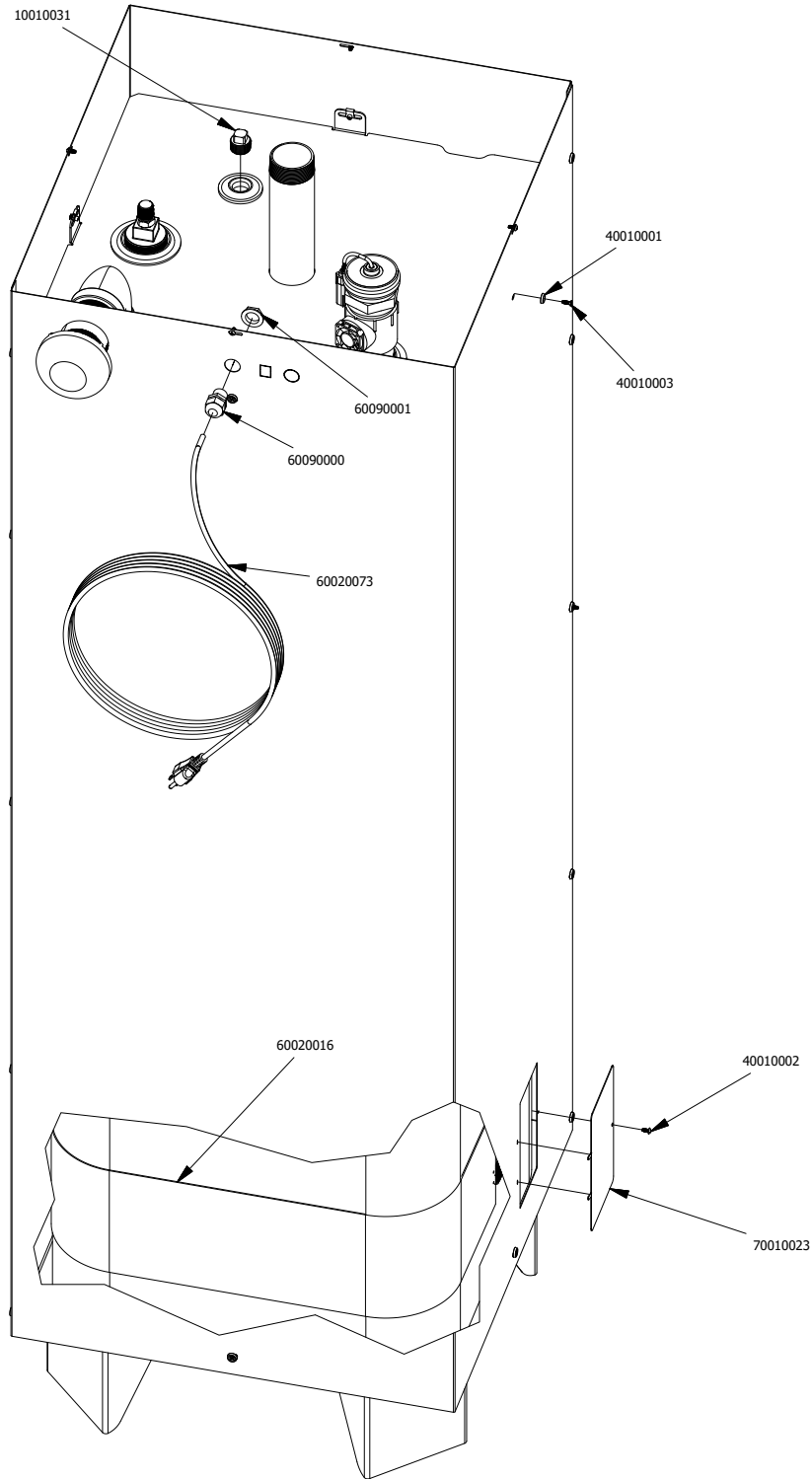

| Part Number | Description | Qty | Part Number | Description | Qty |
|-------------|----------------------------|-----|-------------|-----------------------------------|-----|
| 10010031 | 3/4" Black Iron Plug | 1 | 60020073 | 10' NEMA 5-15P Power Cord | 1 |
| 40010001 | #8 Countersunk SS Washer | 18 | 60090000 | 1/2" NPT Domed Cord Strain Relief | 1 |
| 40010002 | 8-32 X 3/8" Panhead Screw | 10 | 60090001 | 1/2" NPT Nut | 1 |
| 40010003 | 8-32 X 1/2" Flathead Screw | 18 | 70010023 | SS Heater Inspection Cover | 2 |
| 60020016 | 120V 250W Heater Belt | 1 | | | |

FRONTLINE
international
187 ASCOT PARKWAY
CUYAHOGA FALLS, OH 44223

TITLE: 2478SQ-NA-WM Parts View
PART NUMBER: 2478SQ-NA-WM

2/8/24 SHEET 2 OF 3

M3 Gen 3 Control Panel Wiring Diagram

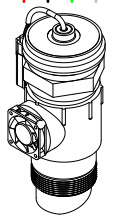
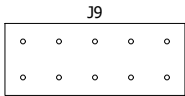
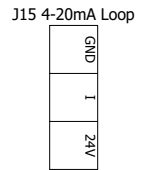
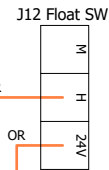
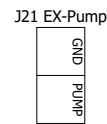
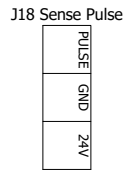
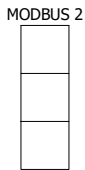
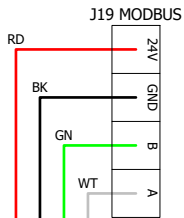
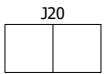
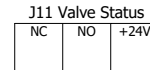
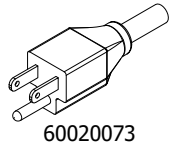
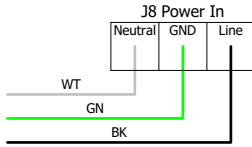
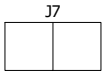
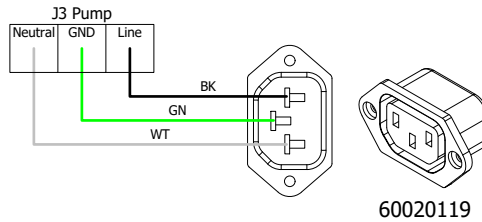
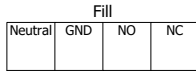
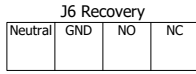
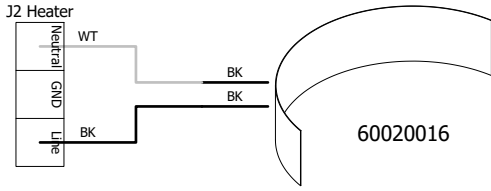

NOTE:
Shield Braid should be connected to GND

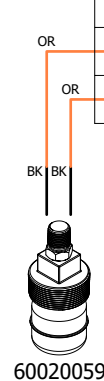

TOLERANCES ARE:
.XX: ± .010
.XXX: ± .005
ANGULAR: ± .5°

FRONTLINE
international

187 ASCOT PARKWAY
CUYAHOGA FALLS, OH 44223

THIS DRAWING IS
CONFIDENTIAL
PROPERTY OF
FRONTLINE
INTERNATIONAL

TITLE 2478SQ-NA-WM Parts View
Wiring Diagram

DRAWN CCB

SHEET 3 OF 3